



WILLARD
INTERCONTINENTAL®
WASHINGTON DC



OVER 200 YEARS
OF PRESTIGIOUS GATHERINGS



GUEST ROOMS AND SUITES

Rooms: 335 Suites: 69 Floors: 12 ADA Rooms: 13

Classic Room: 425-475 sq. ft.
Premium Room: 425 sq. ft.
Junior Suite: 550 sq. ft.
Willard Suite: 600 sq. ft.
One Bedroom Suite: 1,135 sq. ft.

OVAL SUITES

Six Themed Oval Suites averaging 1,100 sq. ft.











SPECIALTY SUITES

Jenny Lind Suite: 960 sq. ft.
Helen Hayes Suite: 1,350 sq. ft.
Henry Augustus Willard Suite: 1,425 sq. ft.
Martin Luther King Jr. Suite: 1,550 sq. ft.

PRESIDENTIAL SUITES

Theodore Roosevelt Suite: 1,700 sq. ft.
George Washington Suite: 1,750 sq. ft.
Abraham Lincoln Suite: 2,100 sq. ft.
Thomas Jefferson Suite: 2,300 sq. ft.

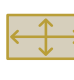

	 Theater Style	 Classroom	 Cocktail Reception	 Banquet	 Crescent Round	 Conference	 Hollow Rectangle	 Size (sq ft)	 Length x Width (ft)	 Height (ft)	 Floor
Grand Ballroom	450	250	600	450	270	50	80	4,736	74 x 64	9.4 & 18	Ballroom Level
Ballroom Foyer	-	-	150	-	-	-	-	2,176	64 x 34	9	Ballroom Level
Buchanan Room	90	60	150	100	60	28	30	1,156	34 x 34	9	Ballroom Level
Garfield Room	40	25	50	30	18	20	20	416	26 x 16	9	Ballroom Level
Pierce Room	220	100	250	200	120	45	60	1,984	64 x 31	9	Ballroom Level
Fillmore Room	40	30	70	30	18	20	20	465	31 x 15	9	Ballroom Level
Taylor Room	50	40	75	40	24	24	24	600	30 x 20	9	Ballroom Level

Willard Room	325	140	350	220	132	60	68	3,120	78 x 40	19	Lobby Level
Crystal Room	250	120	250	210	126	45	60	2,560	64 x 40	15	Lobby Level
Crystal Private Dining Room	-	-	40	-	30	20	-	-	-	-	Lobby Level
Peacock Lounge	60	40	200	60	36	30	30	1,020	34 x 30	9.8	Lobby Level
The Nest	80	45	110	90	54	30	34	900	36 x 25	8	Mezzanine

Grant Suite	28	18	60	24	18	20	26	510	17 x 30	8.3	Second Floor
Chase Room	40	24	50	30	18	20	20	416	26 x 16	8.5	Second Floor
Douglas Room	80	40	75	60	36	28	30	768	30 x 26	8.5	Second Floor
Taft Room	80	40	75	60	36	28	30	780	30 x 26	8.3	Second Floor
Stone Room	40	24	50	30	18	20	20	400	25 x 16	8.5	Second Floor
Brandeis Room	50	30	60	30	18	20	20	512	32 x 16	8.5	Second Floor
Holmes Room	60	30	75	50	30	20	24	580	29 x 20	8.5	Second Floor
Hughes Room	70	30	75	60	36	24	26	510	32 x 32	8.5	Second Floor

Breezeway	-	-	80	-	60	-	-	-	-	-	-
Courtyard	-	-	250	-	-	-	-	-	-	-	-

YOUR SPECIAL DAY

Willard InterContinental is an unmatched venue for a truly special D.C. wedding. From intimate ceremonies to breathtaking ballroom weddings and receptions, plan an unforgettable celebration with sumptuous cuisine, a legendary venue and impeccable service.

MEETINGS AND EVENTS

A distinguished venue for over 200 years Willard InterContinental is the premier meeting space for social and corporate events in Washington, D.C.

With over 22,000 sq. ft. of event space, the hotel features 19 function spaces including three elegant ballrooms.

- Grand Ballroom: 4,736 sq. ft.
- Private Ballroom Foyer: 2,176 sq. ft.
- Willard Room: 3,120 sq. ft.
- Crystal Room: 2,604 sq. ft.



SECOND FLOOR

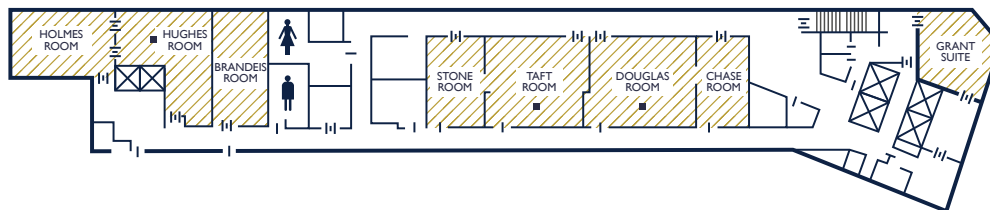

LOBBY LEVEL

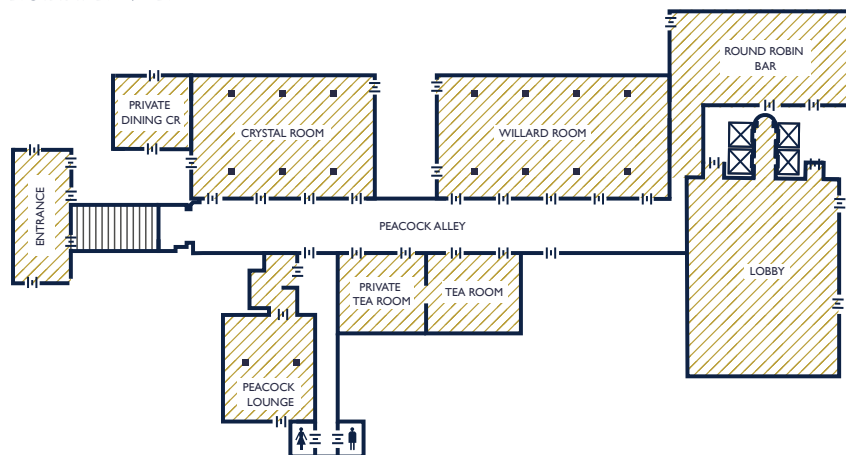

MEZZANINE

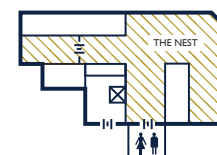

BALLROOM LEVEL

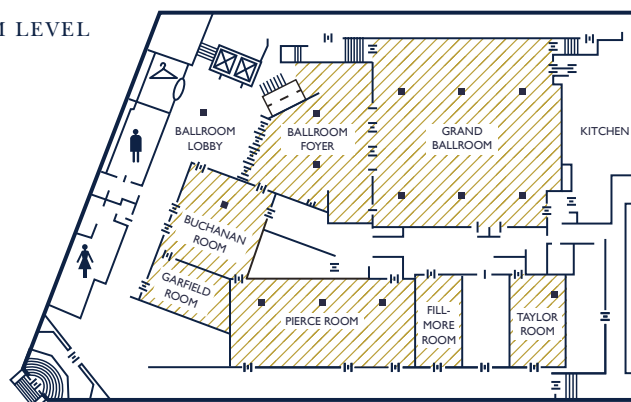

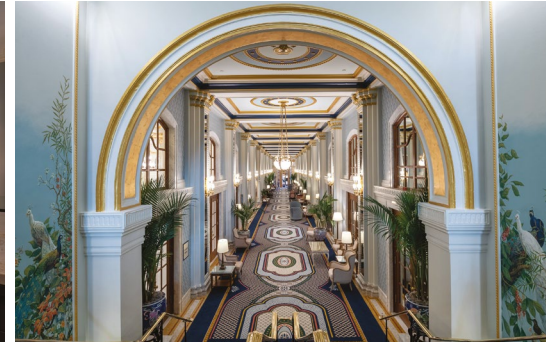

LOCATION

Located in the heart of the nation's capital, and one block from the White House, Willard InterContinental Washington, D.C., one of America's most celebrated historic hotels, is within walking distance to many of the city's most notable attractions, including the iconic monuments, memorials and museums on the National Mall.

HOTEL SERVICES

Willard InterContinental ensures that every guest has access to a wide range of amenities designed for a comfortable and seamless stay. The hotel features a 24-hour fitness center, as well as the luxurious Willard Spa, conveniently located on-site. With a multilingual team fluent in over 40 languages, the hotel provides exceptional service for international guests. Additional services include valet parking, in-room private dining, and daily newspaper delivery. Laundry and dry cleaning services are also available for an additional cost to ensure a truly hassle-free stay. Business travelers benefit from a dedicated Business Center and priority access to Big Whig Media, a cutting-edge multimedia studio equipped with high-definition broadcast facilities, satellite uplink, advanced editing suites, and podcast streaming capabilities. Guests can also explore the on-site Charles Schwartz and Son Jewelers.

CONCIERGE SERVICES

A multi-lingual team, with many of its members a part of the Les Clefs D'Or, a prestigious members-only international association of professional hotel concierges, The Willard's concierge team strives to assist hotel guests make the most of their stay in Washington, D.C. and at the Willard.

FITNESS CENTER

Accessible 24 hours a day, the fitness center is located on the second floor and offers state-of-the-art workout equipment, including cardio bikes by Peloton®, as well as private steam rooms and saunas in both the ladies and men's rooms.

FOOD AND BEVERAGE OUTLETS

Café du Parc: French brasserie with seasonal outside seating and a private dining room

Le Café: Upscale coffee shop

Round Robin Bar: Classic cocktails in a historic setting

Peacock Alley and Willard Tea Room: Seasonal Afternoon Tea

In-Room Dining: Savor world-class cuisine from the privacy of your room

IN-ROOM AMENITIES

Willard InterContinental spacious guest rooms and suites are designed with modern comforts and luxury in mind. Each room features premium linens, full-sized Byredo luxury bath and haircare products, an HDTV with over 90 channels of entertainment, including HBO, Cinemax, and 17 international options. Guests enjoy complimentary Wifi, a Nespresso® espresso maker, a well-stocked minibar, and an in-room safe. Additional conveniences include an iron and ironing board, plush bathrobes and slippers, a hairdryer, a guest room doorbell with a privacy peephole, and personalized in-room climate control.

THE WILLARD SPA

Located on the second floor, The Willard Spa offers an all-encompassing menu of services, including rejuvenating facial skincare, hydrofacial treatments, massage, body treatments, waxing, and beauty services. Reservations are encouraged.

TRANSPORTATION

Ronald Reagan Washington National (DCA): 3.9 miles/15 min.
Washington Dulles International (IAD) 27 miles/45 min.
Baltimore Washington International (BWI) 35 miles/60 min.

Union Station: 1.8 miles/10 min.